

# Artist brief

Ipswich Hospital Transit Lounge



*Caring Better Together*

## Submissions are invited

First Nations artists living in the West Moreton catchment are invited to contribute to a significant new project at Ipswich Hospital.

West Moreton Health is seeking to commission an artwork for the entry corridor of our soon-to-be built Transit Lounge.

This is an opportunity to share culture, stories, and perspectives in a highly visible healthcare setting, helping to create a space that is welcoming, respectful, and culturally strong.

The artwork will support a calm and positive environment for patients, families, and staff. It will reflect themes such as journey, connection, and movement, acknowledging the different experiences people bring to a hospital stay.

The artwork should be sensitive to the healthcare context while offering reassurance, calm and a sense of forward motion – whether the moment signifies a beginning, an ending, or something in between.

First Nations artists and creatives, including those within our workforce and community, are strongly encouraged to submit their initial concept proposal before midnight Sunday 5 July 2026 via the [submission portal](#).

## About the Transit Lounge

When it opens in late 2026, the Transit Lounge will provide a safe and comfortable space for people who are waiting for discharge or transfer.

The Transit Lounge has two main functions:

- Patients waiting to be taken home after their hospital stay can do so in the Transit Lounge. This frees up beds on the wards and improves patient flow in the emergency department.
- Patients awaiting ambulance transfers to another facility can be cared for in the Transit Lounge while they wait. They may be transferring to another hospital, residential aged care, or a rehabilitation service.

The Transit Lounge will therefore be a space of movement, pause, and transition.

For patients, the time they spend in the Transit Lounge will enable them to reflect on a significant milestone in their health journey.

The integration of art in this space will play a vital role in creating a positive and healing environment.



## Site description

The artwork will cover the left wall of the corridor as patients move into the Transit Lounge. The work should be conceived as a continuous visual experience that unfolds with movement, guiding patients and visitors forward.

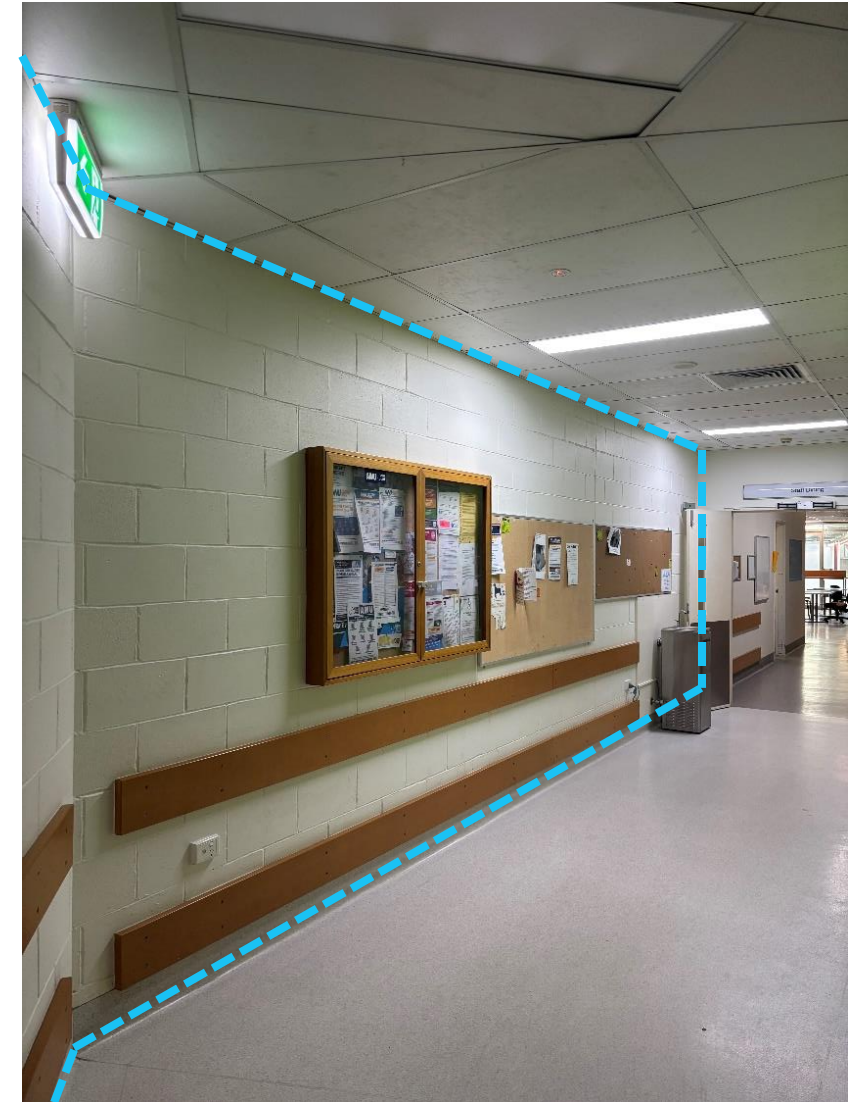
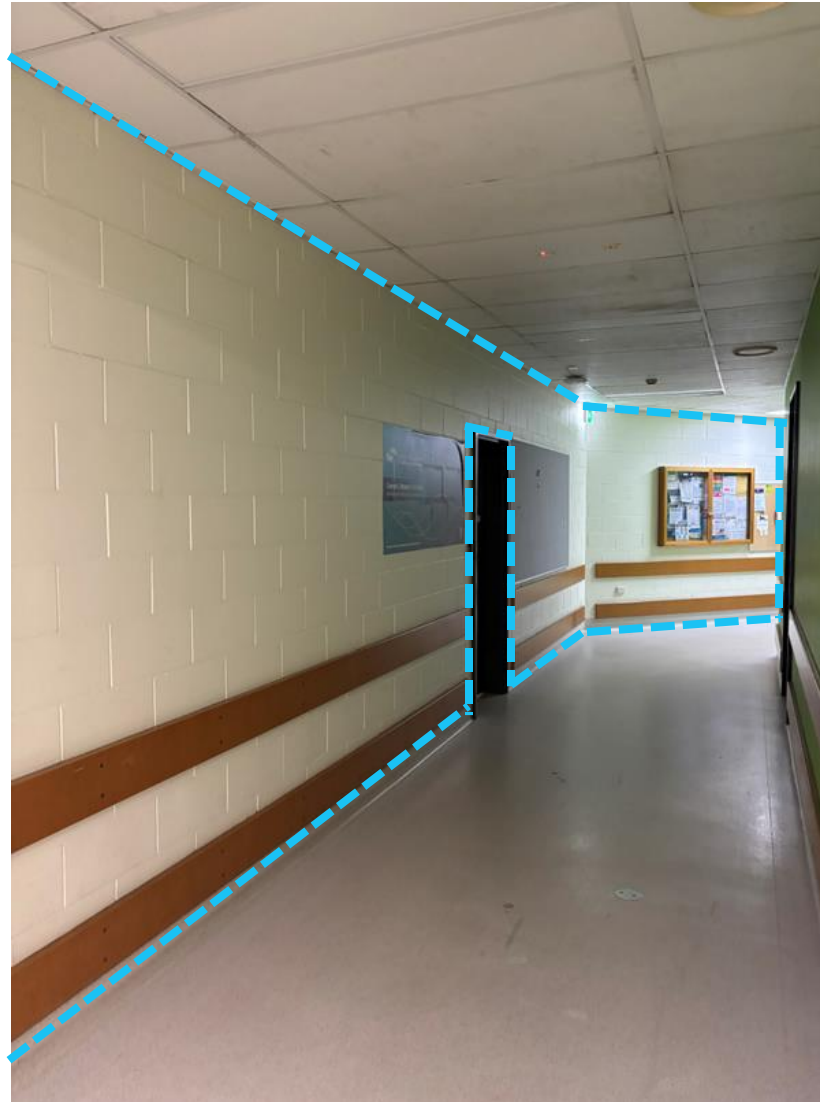
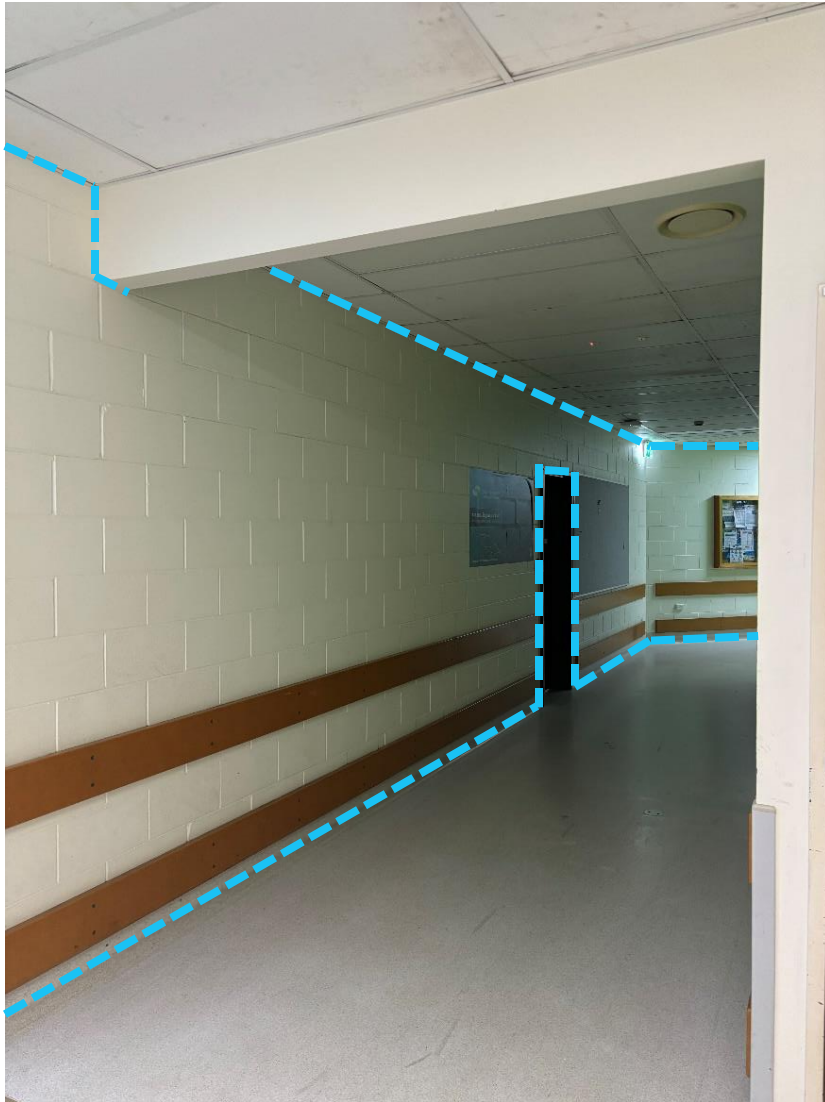

# Specifications

## Approach

Initial proposals must include sketches or concepts, a short statement, and a proposed timeline for the production of a vinyl wall decal. Submissions must include a budget outline.

Shortlisted candidates will be invited to provide a sample of the artwork in digital vector format along with a fully costed quote. A \$500 grant will be provided upon submission. Colours used should complement the colour scheme below.

The final commissioned artwork must be provided by the artist in digital vector format for application as a vinyl decal.

## Transit Lounge colour scheme



1. Floor vinyl
2. Border vinyl
3. Doors and joinery
4. General wall paint
5. Highlight wall colour holding
6. Highlight wall colour lounge

## Themes

The following themes are a guide only:

- journey and movement
- transition, thresholds and passage
- hope, reflection and resilience
- arrival and departure
- continuity, flow and time.

Artists are encouraged to interpret these themes in a way that is inclusive, non-literal and emotionally considerate.

## Dimensions

The artwork should flow cohesively across two adjoining walls with the following dimensions:

- Wall one: 2.55m H x 10.04m W
- Wall two: 2.55m H x 5.07m W

## Shortlisting criteria

Proposals will be assessed on:

- how well the artwork aligns with the brief, themes, colours and specifications outlined here
- ability to meet project timelines
- realistic costing and value.